

## 11.2 Installation of the Cobra L/S to the HP 5890 Gas Chromatograph

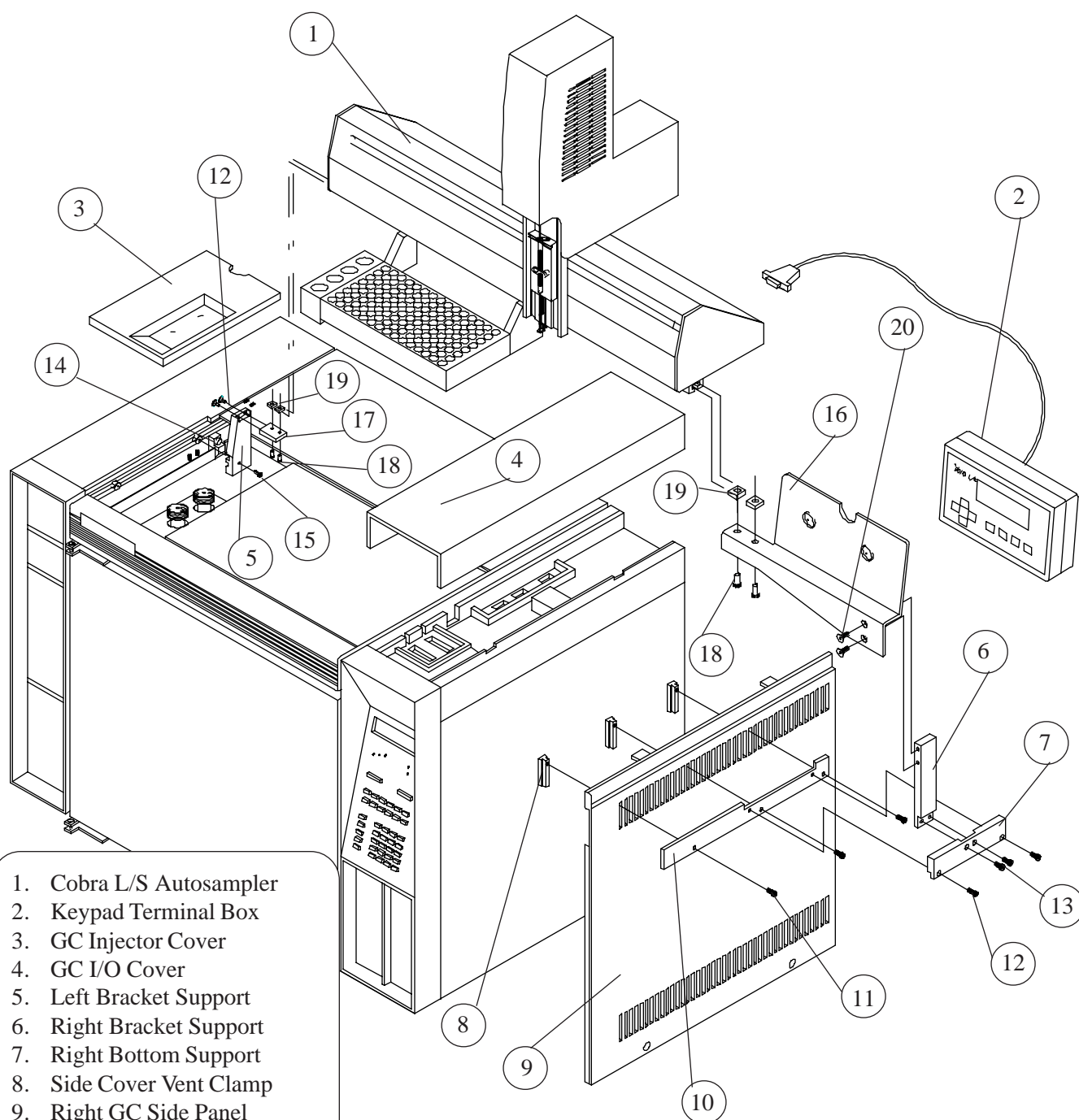

1. Cobra L/S Autosampler
2. Keypad Terminal Box
3. GC Injector Cover
4. GC I/O Cover
5. Left Bracket Support
6. Right Bracket Support
7. Right Bottom Support
8. Side Cover Vent Clamp
9. Right GC Side Panel
10. Side Panel Bracket Support
11. 6-32 x 1/2" SH Screws
12. 8-32 x 1/2" SH Screws
13. 8-32 x 3/8" SH Screws
14. Boss Extension on GC
15. 8-32 x 3/4" SH Screws
16. Keypad Terminal Support
17. Left Tee Slot Block
18. 10-32 x 1/2" SH Screws
19. 10-32 Square Nuts
20. 8-32 x 3/8" Flat Head Screw