

11.3 Installation of the Cobra L/S to the HP 6890 Gas Chromatograph

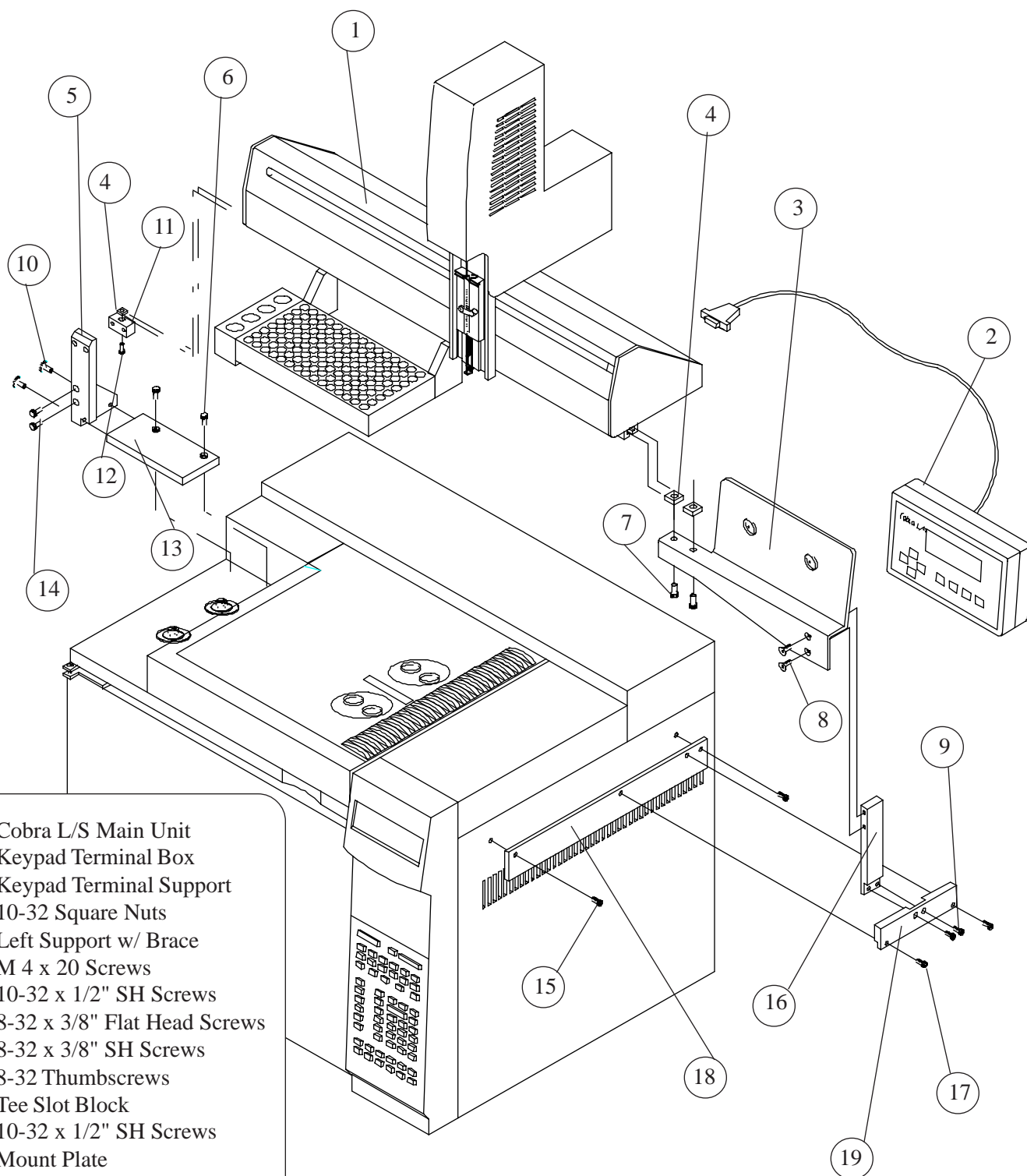

1. Cobra L/S Main Unit
- 2.. Keypad Terminal Box
3. Keypad Terminal Support
4. 10-32 Square Nuts
5. Left Support w/ Brace
6. M 4 x 20 Screws
7. 10-32 x 1/2" SH Screws
8. 8-32 x 3/8" Flat Head Screws
9. 8-32 x 3/8" SH Screws
10. 8-32 Thumbscrews
11. Tee Slot Block
12. 10-32 x 1/2" SH Screws
13. Mount Plate
14. 10-32 x 1/2" SH Screws
15. M 4 x 20 Screws
16. Right Support
17. 8-32 x 1/2 SH Screws
18. Right GC Mount Plate
19. Right Mount Bar