

Connectors

Caps

O-Rings

Valves

Stopcocks

Filters

Injection Sites & Sampling Ports

Clamps, Clips & Cable Ties

Tubing

Extension Lines

Guide Wire Accessories

Needles

Dilators & Introducer Sheaths

Spikes

Chambers

Bags

Ports & Flanges

Syringes

Tools

Sterilization Supplies

Applicators, Swabs & Brushes

Containers

Scoops & Spoons

Dispensers

Drapes, Towels & Bandages

Clothing

CONNECTORS

Quick Disconnect Couplings
Life Sciences – Medical & Bioprocessing



Shown Assembled



HFC39

HFC39 Series aseptic disconnect couplings prevent external organisms from entering into the media flow path upon disconnection. Automatic shut-off valves close off the flow path aseptically, protecting valuable media while also eliminating the need for pinch clamps and tube welders. The easy-to-use thumb latch design provides a secure, leak-free connection and enables one-hand disconnects.

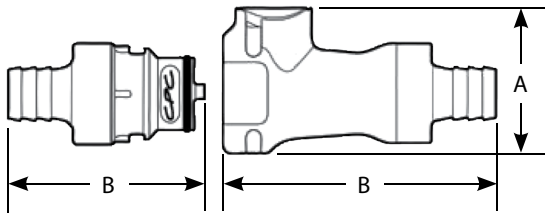

Single Shut-Off
Double Shut-Off

A = Height/Diameter
B = Total Length

Coupling Bodies

In-Line Hose Barb, PSU, SS, Silicone				
Shut-Off	Tubing Size	Flow	A x B	
HFCD17439M	1/4 inch ID Tubing (6.4 mm)	1/4 inch (6.4 mm)	1.44 inch x 2.82 inch (36.6 mm x 71.6 mm)	
HFCD17639M	3/8 inch ID Tubing (9.5 mm)	3/8 inch (9.5 mm)	1.44 inch x 2.82 inch (36.6 mm x 71.6 mm)	
HFCD17839M	1/2 inch ID Tubing (12.7 mm)	3/8 inch (9.5 mm)	1.44 inch x 2.82 inch (36.6 mm x 71.6 mm)	

Coupling Inserts

In-Line Hose Barb, PSU, Silicone				
Straight Thru	Shut-Off	Tubing Size	Flow	A x B
HFC22439M	HFCD22439M	1/4 inch ID Tubing (6.4 mm)	1/4 inch (6.4 mm)	1 inch x 2.02 inch (25.4 mm x 51.3 mm)
HFC22639M	HFCD22639M	3/8 inch ID Tubing (9.5 mm)	3/8 inch (9.5 mm)	1 inch x 2.02 inch (25.4 mm x 51.3 mm)
HFC22839M	HFCD22839M	1/2 inch ID Tubing (12.7 mm)	3/8 inch (9.5 mm)	1 inch x 2.02 inch (25.4 mm x 51.3 mm)

QOSINA
Thousands of Stock Components



QOSINA
Thousands of Stock Components



CONNECTORS

Quick Disconnect Couplings
Life Sciences – Medical & Bioprocessing

Steam-Thru®



The Steam-Thru® Series Connections allow a quick and easy sterile connection between biopharmaceutical processing equipment and disposable bag and tube assemblies. Its innovative three-port design allows a true steam-through SIP (Steam-In-Place) process, which eliminates “dead legs” where bacteria can grow. The patented valve allows a sterile connection and disconnection and permits a high media flow rate. The single-use design saves time and money by eliminating unnecessary cleaning procedures and reducing validation concerns associated with reusable components. The original Steam-Thru® Connector is a single-actuation design allowing the connector to be steamed once in making a connection “steam on.” The Steam-Thru II Connector is a dual-actuation design which allows the connector to be steamed a second time to “steam off” again.

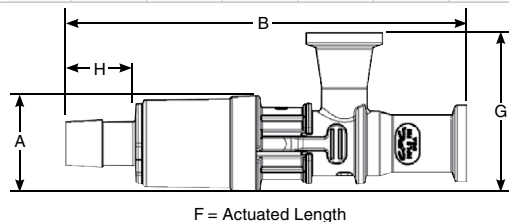

Straight-Through

A = Height/Diameter
B = Total Length
F = Actuated Length
G = Total Height
H = Hose Barb Length

Steam-Thru® Connectors, PSU, Silicone, PE		
Part No.	Sanitary SIP Connector x Sanitary SIP Connector x Hose Barb	A x B x F x G x H
STC1700300	3/4 inch x 1 1/2 inch x 3/8 inch (0.75 inch x 1.5 inch x 0.375 inch 19.1 mm x 38.1 mm x 9.5 mm)	1.2 inch x 4.8 inch x 4.15 inch x 2 inch x 0.6 inch (30.5 mm x 121.9 mm x 105.4 mm x 50.8 mm x 15.2 mm)

Website NEW : www.chromalytic.net.au E-mail : info@chromtech.net.au Tel: 03 9762 2034 . . . in AUSTRALIA

HRMalytic +61(0)3 9762 2034

ECHnology Pty Ltd

Australian Distributors
Importers & Manufacturers
www.chromtech.net.au

Connectors

Caps

O-Rings

Valves

Stopcocks

Filters

Injection Sites & Sampling Ports

Clamps, Clips & Cable Ties

Tubing

Extension Lines

Guide Wire Accessories

Needles

Dilators & Introducer Sheaths

Spikes

Chambers

Bags

Ports & Flanges

Syringes

Tools

Sterilization Supplies

Applicators, Swabs & Brushes

Containers

Scoops & Spoons

Dispensers

Drapes, Towels & Bandages

Clothing